

ULISSE MAXI NETCAM

FULL IP PTZ UNIT FOR NETWORK CAMERAS FOR DYNAMIC MONITORING OF LARGE OUTDOOR AREAS



MAIN FEATURES

| |
|---|
| Weatherproof housing for large-size lenses |
| Camera and lens maximum allowed weight of 7.6kg (17lb) |
| For Network cameras compatible with ONVIF protocol, Profile S, or equipped with RS485 serial port |
| Direct access to camera web pages via VT Tunneling |
| Autopan, Preset, Patrol |
| Variable speed: 0.02°-20°/s Pan and Tilt |
| Horizontal continuous rotation, vertical +45°/-20° |
| Optical sensors for absolute positioning feedback |
| Position accuracy: 0.02° |
| Up to 250 Presets |
| Integrated wiper |
| Total control of the auxiliary functions through the Videotec PTZ ASSISTANT |
| Operating temperature: -10°C / +60°C (14°F / 140°F) |
| Power supply: 230Vac, 24Vac or 120Vac |

OPTIONS:

| |
|---|
| Germanium window for thermal cameras |
| Rearrangement for mounting of two UPTIRN LED illuminators |

DESCRIPTION

ULISSE MAXI NETCAM is a powerful Full-IP PTZ for outdoor IP video surveillance, which can manage modern IP SD, HD and Megapixel cameras, with integration in a network system.

This model can contain and manage the largest motorised lenses on the market, with a total weight of up to almost 8 kilos.

This way a single unit can provide a 360° coverage of the area to be monitored.

A special feature of ULISSE MAXI NETCAM is the ability to easily control, via the network, all the camera's pan & tilt functions, including wiper, preset and set-up, using the most common VMS on the market.

It is possible to use any ONVIF compatible Profile S camera, or proprietary protocol on RS-485, whilst the entire management of the system only requires an IP address.

The Videotec's PTZ ASSISTANT plug-in software supports any VMS with the control of all special functions such as wiper, washer pump and IR.

The unit is equipped with a wiper for removing rain and dust from the front glass; there is a wide selection of jerry cans with washer pump, different capacities and heads.

To ensure detailed images even during the night hours, versions are available with LED illuminators, with infrared light or white light.

The sturdy mechanical structure and the powerful motors of this PTZ are designed to guarantee maximum resistance to high operating stress, vibrations and temperatures between -10°C to +60°C.

The unit is equipped with optical sensors which ensure the accurate control of the position in any condition of use.

Models are available for vision with a thermal camera.



ULISSE MAXI NETCAM + 2 UPTIRN



ULISSE MAXI + UPTWB TAB

TECHNICAL DATA

GENERAL

Constructed from aluminium and tecnopolymer
 Epoxypolyester powder painting, RAL9002 colour
 Top mount (OTT)
 Transmission through toothed belt
 Slip-ring
 Electronic limit switches
 Simplified installation thanks to the connector and easy replacement on-site
 Zero backlash
 Max weight camera+lens: 7.6kg (17lb)
 Encoder for absolute positioning
 Configuration of telemetry protocol parameters through dip-switch for RS-485

MECHANICAL

Cable glands: 3xM16
 Horizontal rotation: continuous
 Vertical rotation: from +45° up to -20°
 Horizontal speed (variable): from 0.02°/s up to 20°/s
 Tilt speed (variable): from 0.02°/s up to 20°/s
 Internal usable area: See drawings
 Enclosure glass window (WxH): 112x95mm (4.4x3.7in)
 Accuracy of preset positions: 0.02°
 Unit weight: 30kg (66lb)
 ULISSE MAXI NETCAM, for thermal cameras:
 Germanium window

- Diameter: 85mm (3.3in) (external), 70mm (2.8in) (usable diameter)
- Thick: 2mm (0.07in)
- External scratch-resistant treatment: Hard Carbon Coating (DLC)
- Internal antireflection treatment

 Spectral range: from 7.5µm up to 14µm
 Medium transmittance (from 7.5µm up to 11.5µm): 94%
 Medium transmittance (from 11.5µm up to 14µm): 90%

ELECTRICAL

Suitable for use with network cameras
 Power supply/Current consumption:

- 230Vac, 0.4A, 50/60Hz
- 24Vac, 4A (8A, with LED illuminators), 50/60Hz
- 120Vac, 0.8A, 50/60Hz

 Power consumption:

- 100W
- 150-190W max with LED illuminators in 24Vac
- 24W, P&T static, heating switched off

 Camera power supply: 12Vdc (800mA)
 4 self-powered alarm inputs
 2 dry contacts: 30Vdc max or 30Vac, @ 1A

COMMUNICATIONS

Ethernet connection: IEEE 802.3 100Base-Tx

PROTOCOLS

ONVIF, Profile S

ENVIRONMENT

Indoor/Outdoor
 Operating temperature (with heater): from -10° (14°F) up to +60°C (140°F)
 Surge immunity: up to 2kV line to line, up to 4kV line to earth (Class 4)

CERTIFICATIONS

Electrical safety (CE): EN60950-1
 Electromagnetic compatibility (CE): EN50130-4, EN55022 (Class A), FCC Part 15 (Class A)
 Outdoor installation: EN60950-22
 Photobiological safety (CE): EN62471 (LED illuminators)
 IP protection degree: EN60529 (IP66)
 Salty fog resistance: EN50130-5, EN60068-2-52
 EAC certification

ACCESSORIES

| | |
|-----------------|--|
| UPTJBUL | Junction weatherproof box for cables connexion (according UL norm) |
| UPTIRN108A00 | LED illuminator for ULISSE, 10°, 850nm, 24Vac - 12/24Vdc |
| UPTIRN308A00 | LED illuminator for ULISSE, 30°, 850nm, 24Vac - 12/24Vdc |
| UPTIRN608A00 | LED illuminator for ULISSE, 60°, 850nm, 24Vac - 12/24Vdc |
| UPTIRN109A00 | LED illuminator for ULISSE, 10°, 940nm, 24Vac - 12/24Vdc |
| UPTIRN309A00 | LED illuminator for ULISSE, 30°, 940nm, 24Vac - 12/24Vdc |
| UPTIRN10WA00 | LED illuminator for ULISSE, 10°, white light, 24Vac - 12/24Vdc |
| UPTIRN30WA00 | LED illuminator for ULISSE, 30°, white light, 24Vac - 12/24Vdc |
| UPTIRN60WA00 | LED illuminator for ULISSE, 60°, white light, 24Vac - 12/24Vdc |
| UPTIRPS230N | External power supply for ULISSE series, prearranged for two LED illuminators, and control to synchronize IR illuminators with camera Day/Night switching, IN 230Vac, in weatherproof box. Twilight sensor included. |
| UPTIRPS100N | External power supply for ULISSE series, prearranged for two LED illuminators, and control to synchronize IR illuminators with camera Day/Night switching, IN 100Vac, in weatherproof box |
| UPTIRPS120UL | External power supply for ULISSE series, prearranged for two LED illuminators, and control to synchronize IR illuminators with camera Day/Night switching, IN 120Vac, in weatherproof box. Twilight sensor included. |
| WASPT0V5L5M00 | Water tank 5l (1 gal), pump with delivery up to 5m (16ft), IN 230Vac-24Vac-120Vac |
| WASPT0V23L5M00 | Water tank 23l (6 gal), pump with delivery up to 5m (16ft), IN 230Vac-24Vac-120Vac |
| WASPT0V23L11M00 | Water tank 23l (6 gal), pump with delivery up to 11m (36ft) with water floating, IN 230Vac-24Vac-120Vac |
| WASPT1V23L30M00 | Water tank 23l (6 gal), pump with delivery up to 30m (98ft) with water floating, IN 230Vac |
| WASPT3V23L30M00 | Water tank 23l (6 gal), pump with delivery up to 30m (98ft) with water floating, IN 120Vac |

BRACKETS AND ADAPTORS

| | |
|----------|---|
| UPTWBA | Wall bracket with internal cable channel |
| UPTWBTAB | Parapet bracket with internal cable channel |

PACKAGE

| Model Number | Weight | Dimensions (WxHxL) | Master carton |
|--------------|-------------|---------------------------|---------------|
| UPT1SLWAN00E | 38kg (84lb) | 76x41x67cm (30x16x26.4in) | - |

ULISSE MAXI NETCAM - CONFIGURATION OPTIONS

| | Voltage | | Options | | Video Output | |
|------------|-----------------|-----------|--|----------|---|------------|
| UPT | 1 230Vac | SL | W 230Vac and 120Vac, with wiper | A | N For Network cameras compatible with ONVIF protocol, Profile S, or with built-in telemetry output | 00E |
| | 2 24Vac | | J 24Vac, with wiper and prearrangement for mounting of two UPTIRN (illuminators not included) | | | |
| | 3 120Vac | | G With germanium front window for thermal camera applications | | | |

Not all combinations are possible.

TECHNICAL DRAWINGS

Sizes in millimeters.

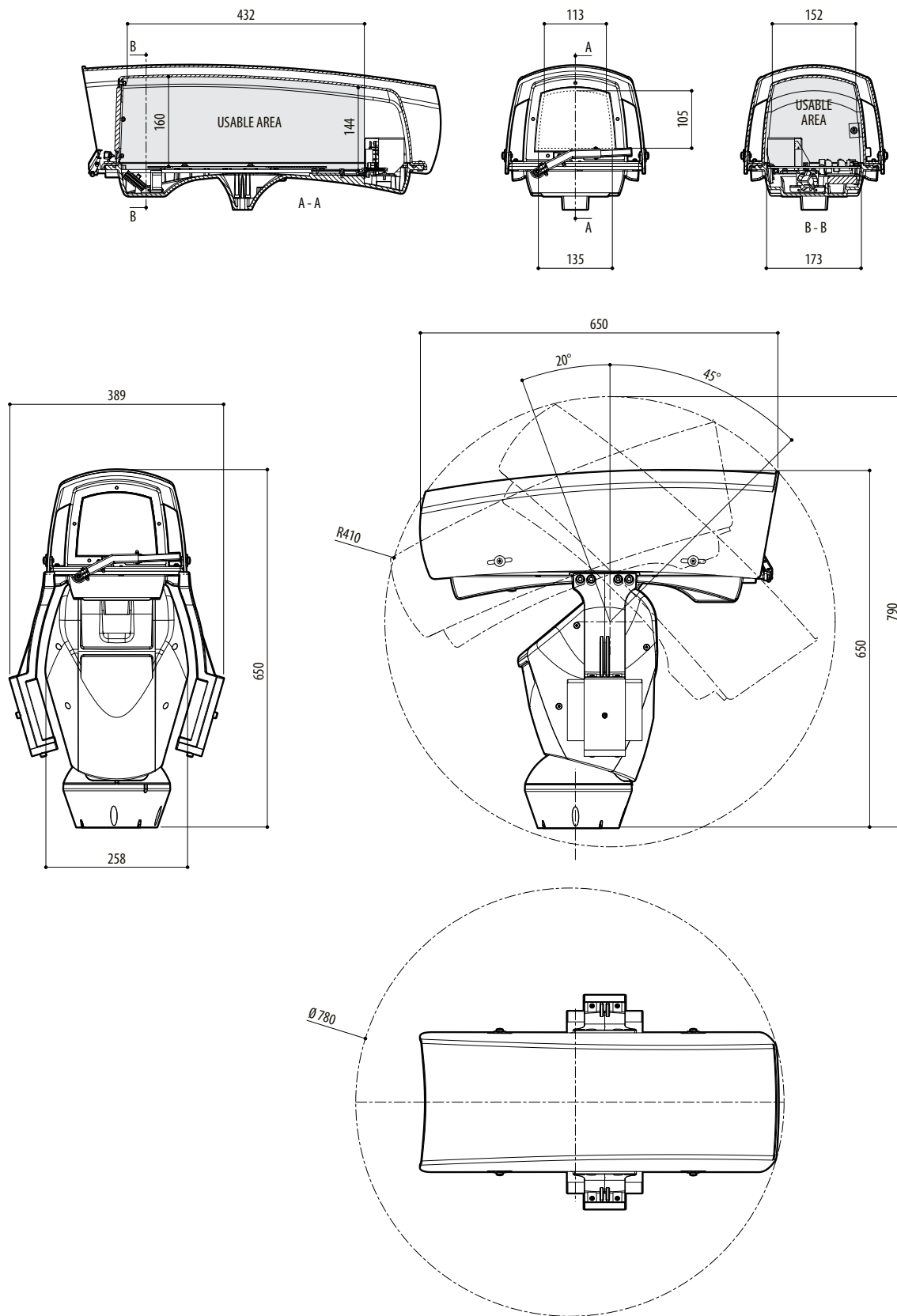

ULISSE MAXI

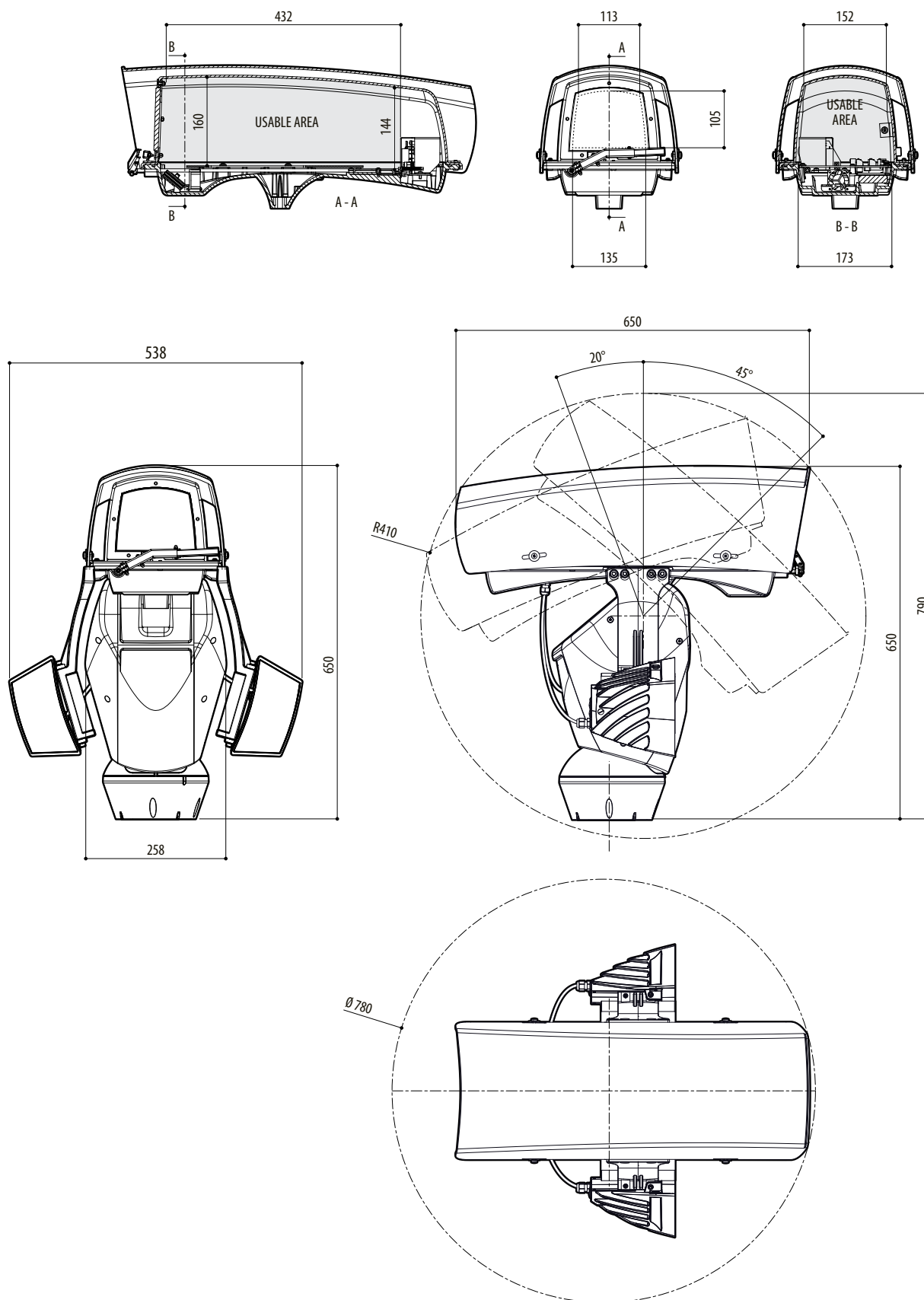

ULISSE MAXI NETCAM, PRE-ARRANGED VERSION FOR TWO LED ILLUMINATORS INSTALLATION

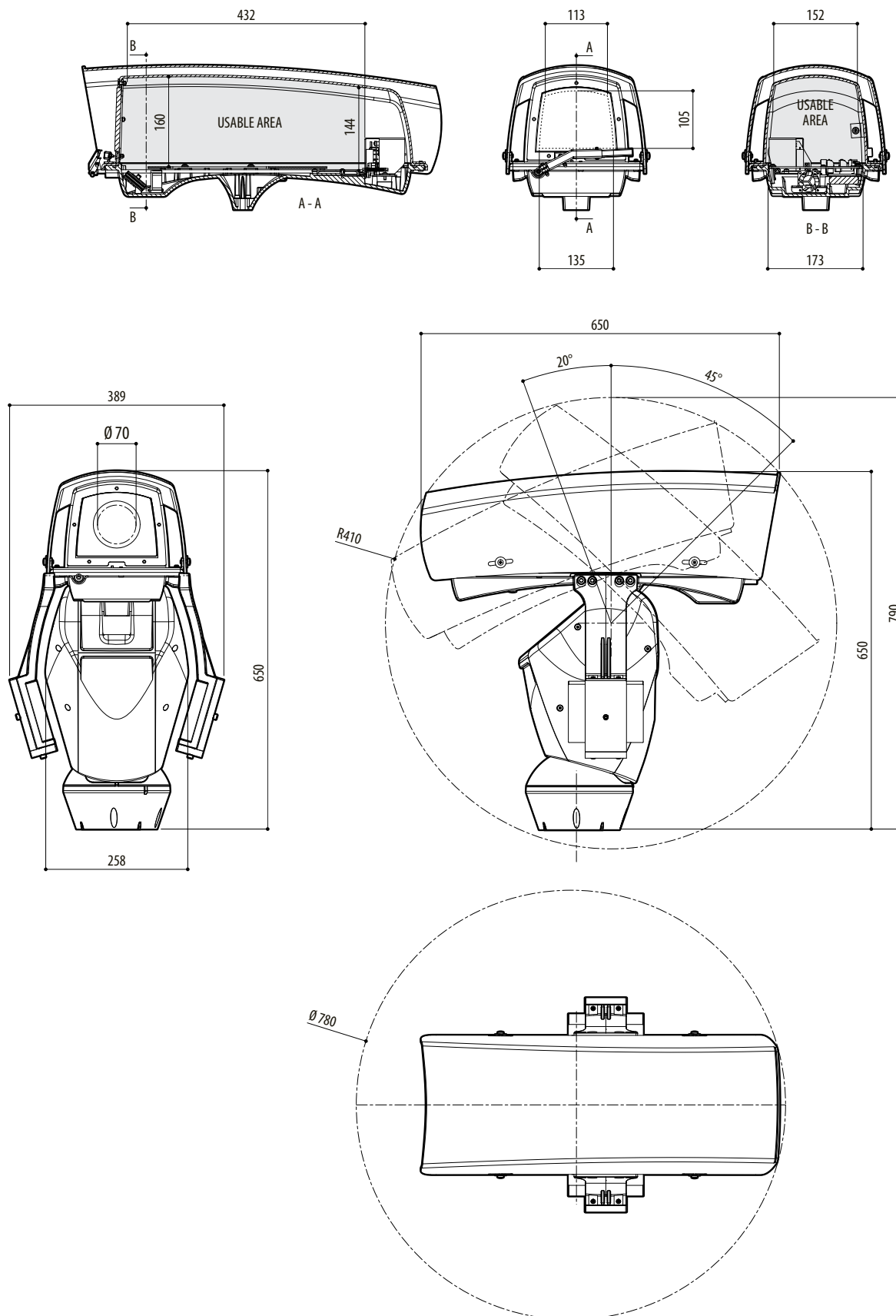

ULISSE MAXI NETCAM, VERSION FOR THERMAL CAMERAS

